



Essential SmartBright G2 LED Downlight DN029B

DN029B G2 LED12/CCT PSR-E D150 CAU

The Philips SmartBright G2 LED downlight provides a professional and flexible solution for a wide variety of applications. Offering three selectable colour temperatures plus integrated dimming capability, the G2 downlight makes it really easy to create the perfect ambience for your unique environment. This affordable and quick to install fitting delivers high energy savings without compromising on light quality.

Product data

General Information		Controls and Dimming	
Lamp colour code	3000/4000/6500	Dimmable	Yes
Light source	No replaceable		
Luminaire light beam spread	100°	Mechanical and Housing	
Connection	Plug-in connector 2-pole	Housing material	Metal-Plastic
Protection class IEC	Safety class II (II)	Reflector material	Polycarbonate
		Optic material	Polycarbonate
		Fixation material	Stainless steel
		Optical cover/lens finish	Frosted
Operating and Electrical		Overall length	114 mm
Input Voltage	220 to 240 V V	Overall width	114 mm
Input frequency	50 or 60 Hz	Overall height	61 mm
Power factor (min.)	0.8	Overall diameter	190 mm
		Colour	White

Essential SmartBright G2 LED Downlight DN029B

Dimensions (height x width x depth)	61 x 114 x 114 mm (2.4 x 4.5 x 4.5 in)
Approval and Application	
Ingress protection code	IP40/IP54 front
Mech. impact protection code	IK03 [0.3 J]
Initial Performance (IEC Compliant)	
Initial luminous flux	1200 lm
Initial LED luminaire efficacy	114.00 lm/W
Lamp colour temperature	3000 4000 6500 K
Colour Rendering Index	80
Initial chromaticity	(3000K@, 0.4400, 0.40304000K@0.37600.36566500K@0.31300.3370) 6
Initial input power	10.5 W
Power consumption tolerance	+/-10%
Over Time Performance (IEC Compliant)	
Median useful life	30000 h
L70B50	

Application Conditions	
Ambient temperature range	-20 to +40 °C
Product Data	
Full product code	871951425187800
Order product name	DN029B G2 LED12/CCT PSR-E D150 CAU
EAN/UPC – product	8719514251878
Order code	929002531619
Local order code	DN029BL12CCT150
Numerator – quantity per pack	1
Numerator – packs per outer box	6
SAP material	929002531619
SAP net weight (piece)	0.420 kg



Dimensional drawing

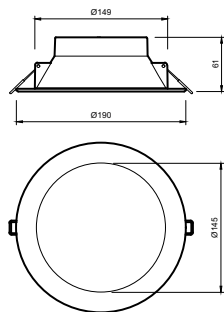

DN029B G2 LED12 3CCT 15W D150 DIM AU

